

# LIFTLUX

SL66-8 / SL85-10 / SL105-10

## Middle & narrow range



Electrical Platform



### Manœuvrability



### Stability



### Durability



## LIFTLUX

Think Bigger

## Specifications

	SL 66-8	SL 85-10	SL 105-10
Working height (m)	8.6	10.5	12.5
Platform height (m)	6.6	8.5	10.5
Platform Capacity (kg)	400/200	400/200	400/200
Overall height (m)	2.22	2.44	2.64 <b>(B)</b>
Platform height stowed (m)	1.72	1.94	2.00 <b>(C)</b>
Length stowed (m)	2.70	2.70	2.70 <b>(D)</b>
Width (m)	0.80	1.00	1.00 <b>(E)</b>
Platform size (m)	2.65 x 0.8	2.65 x 1.0	2.65 x 1.0 <b>(F)</b>
Platform length fully extended (m)	4.45 x 0.8	4.45 x 1.0	4.45 x 1.0
Wheelbase (m)	2.00	2.00	2.00 <b>(H)</b>
Controls	SW	SW	SW
Travel speed (km/h)	3.5	3.5	3.5
Turning radius (m) Inside	0.9	0.8	0.8
Outside	2.8	3.1	3.1
Lift / Lower (sec)	40/30	45/30	50/35
Ground clearance (cm)	10	10	10
Gradeability	25%	25%	25%
Fold down - Take Out platform rails	T.O.	T.O.	T.O.
Charger (A)	25	25	30
Battery (A/h)	160	160	210
Weight (kg)	1,900	1,900	2,500

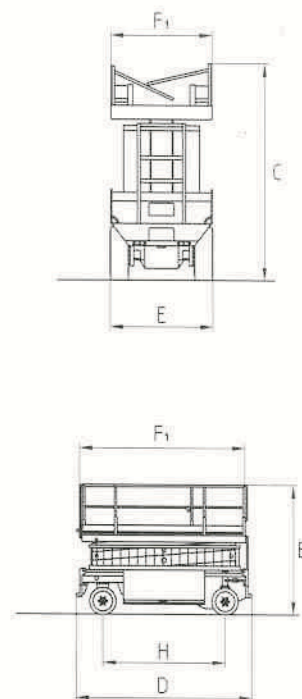

## After Sales Service & Parts

LIFTLUX POTAIN GMBH

DIESELSTRASSE 1

D-66763 DILLINGEN

Tél. +49 (0) 68 31-97 48-0

Fax +49 (0) 68 31-97 48-50

Distributed by :



Manitowoc Crane Group

**LIFTLUX** GmbH

Think Bigger